

时尚空间

品鉴全球设计 引领空间潮流

041 · December / 杭州一味坊会所 林琮然 / 泉州浦西万达广场购物中心 冯厚华 / 慕尼黑机场VIP WING休息厅 Erich Gassmann, Tina Abmann / Chalachol发廊 Nattapon Klinsuwan / 无锡西水墅会所 冯嘉云 / 广州朗汇会所 黄汇源 / 荷兰AsGoodAsNew品牌游击店 i29 interior architects / 斯洛文尼LOLITA咖啡馆

专题 Topic

专题会所 用设计寻求共鸣

41
¥35.00

ISSN 2074-8701



9 772074 870001

定价：¥35.00

优雅对话

德国 Spiegelkantine 明镜周刊员工餐厅

采编 > 谢雪婷 文编 > 孙丽雅 翻译 > 巫雯锦 摄影 > Zoocy Braun

项目享有建筑内的突出位置和室内空间的高能见度，体现了杂志社新闻工作者的理念及对话文化。尽管如此，它只是个内部空间，仅向明镜周刊的员工和他们的客户开放，这意味着这家餐厅并不是一个“品牌空间”。由此，设计方案讨论的出发点是空间和建筑的特点。这栋建筑以其露出水面的绝佳位置和现代建筑风格为特色，突出14层楼高的中庭内分布的垂直室内空间。餐厅是一个大而多边形的空间，两边分布着一排连续的窗户，进一步突出了空间强烈的水平印象。

空间必须是灵活的，因此天花板的设计是餐厅设计的亮点。设计采用了不光滑、闪闪发光的天花板，由4230个圆形微穿孔铝组成，覆盖上吸音材料，以微小角度拼接，形成水面，反射光线。白天，餐厅周围地区的水和光线反射在天花板上，为空间带来生气。不光滑的闪闪发光“板”吸收日光，形成闪亮耀眼的屋顶，显得生动活泼。大规模的光盘涂上强色，将空间划分成不同区域，形成积极的空间氛围，即使外面天气阴沉，室内仍五彩斑斓。餐桌上方悬挂着可调光灯。夜晚，光盘变成间接照明对象，悬挂灯具形成温暖的白色“环境光”棚，定义了整个餐厅的空间氛围。悬浮灯具的间接光源照亮了天花板上的圆形光盘。集中射灯隐藏在天花板内。墙壁照明装置在墙面上投射下均匀的光线，平衡了水平与垂直照明设施，优化了夜间的空间感。

天花板同时具有功能上的优势：掉线板上区域被漆成黑色，隐藏强制性技术配件。天花板出风口和洒水装置同样隐藏不见。此外，较高的天花板配置上吸音装置，补充了穿孔板的吸音功能。

圆形餐桌采用黑色镀层钢板框架，仿如优雅地从地面上生长而出。花岗岩平板则是桌面，映衬这天花板照明，形成炫目的光辉。餐桌被分成三部分摆放，在多边形的楼层平面上有机摆放，从而清晰界定出运动区，白色光滑的水磨石地面上清晰可见三条线条，沿着这三条线条分布的是四个区域。大大的黄色灯光碟就像挂灯一样，悬挂在餐桌上方。木镶板给空间结构枢纽增添深邃感。垂直、波浪形的粉刷、涂漆表面显得更为深邃，营造织纹效果。

之字形的波浪外观为室内空间营造一个独立区域，静静矗立在餐厅的一端。一簇明亮的、悬挂树脂玻璃棒营造温馨氛围。这个区域和餐厅间的玻璃外立面形成双反射玻璃，所以当餐厅和这个独立区域都被使用时，它们之间的间隔几乎是无形的，但是，当餐厅不营业的时候，餐厅空间变黑了，外立面就呈现一半镜子、一半透明的效果。

项目在满足功能要求的同时营造强烈的视觉冲击，形成一个真正有特色的空间。它支持着公司内部成熟的交流文化，并以高姿态将这些价值传达给外界。



Elegant Dialogue The Employee's Canteen of Spiegelkantine, Germany

业主: Verlagsgruppe De SPIEGEL
地址: 德国汉堡市
面积: 525平方米
设计团队: Peter Ippolito, Gunter Fleitz,
Tilla Goldberg, Christian Kirschenmann,
Tim Lessmann, Alexander Fehre, Christine
Ackermann, Roger Gasperlin, Katja Heineman
设计公司: Ippolito Fleitz Group 事务所
照明设计: Gerd Pfarré

Location: Hamburg, Germany
Area: 525 m²
Design Team: Peter Ippolito, Gunter Fleitz,
Tilla Goldberg, Christian Kirschenmann, Tim
Lessmann, Alexander Fehre, Christine Ackermann,
Roger Gasperlin, Katja Heinemann
Design Company: Ippolito Fleitz Group
Lighting Design: Gerd Pfarré

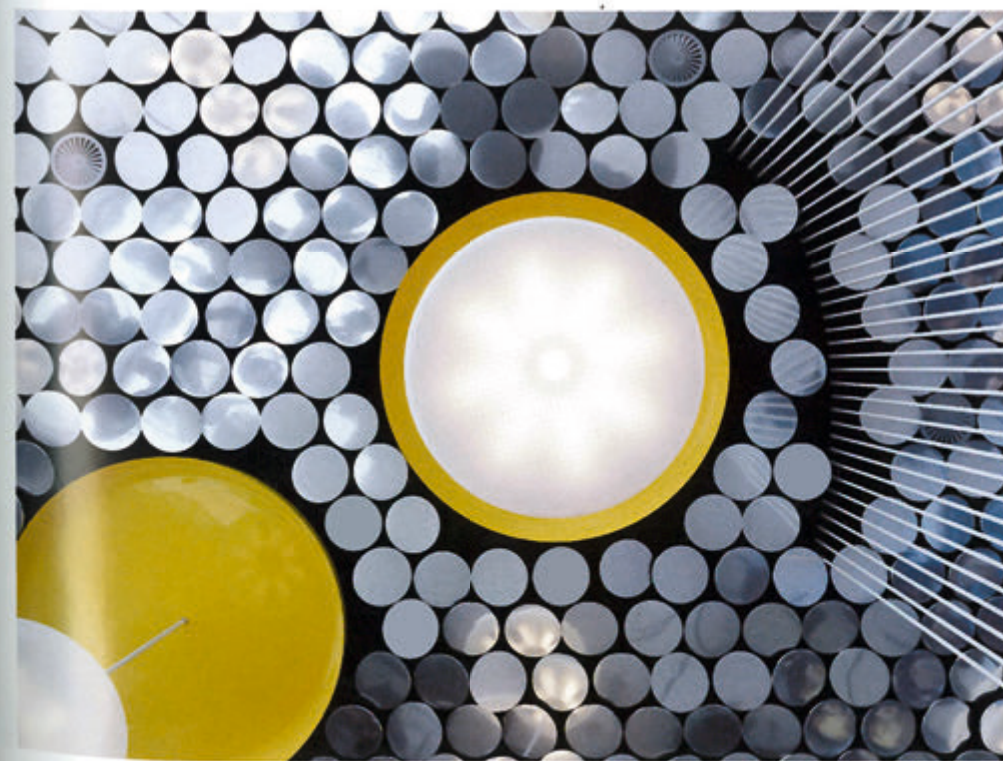
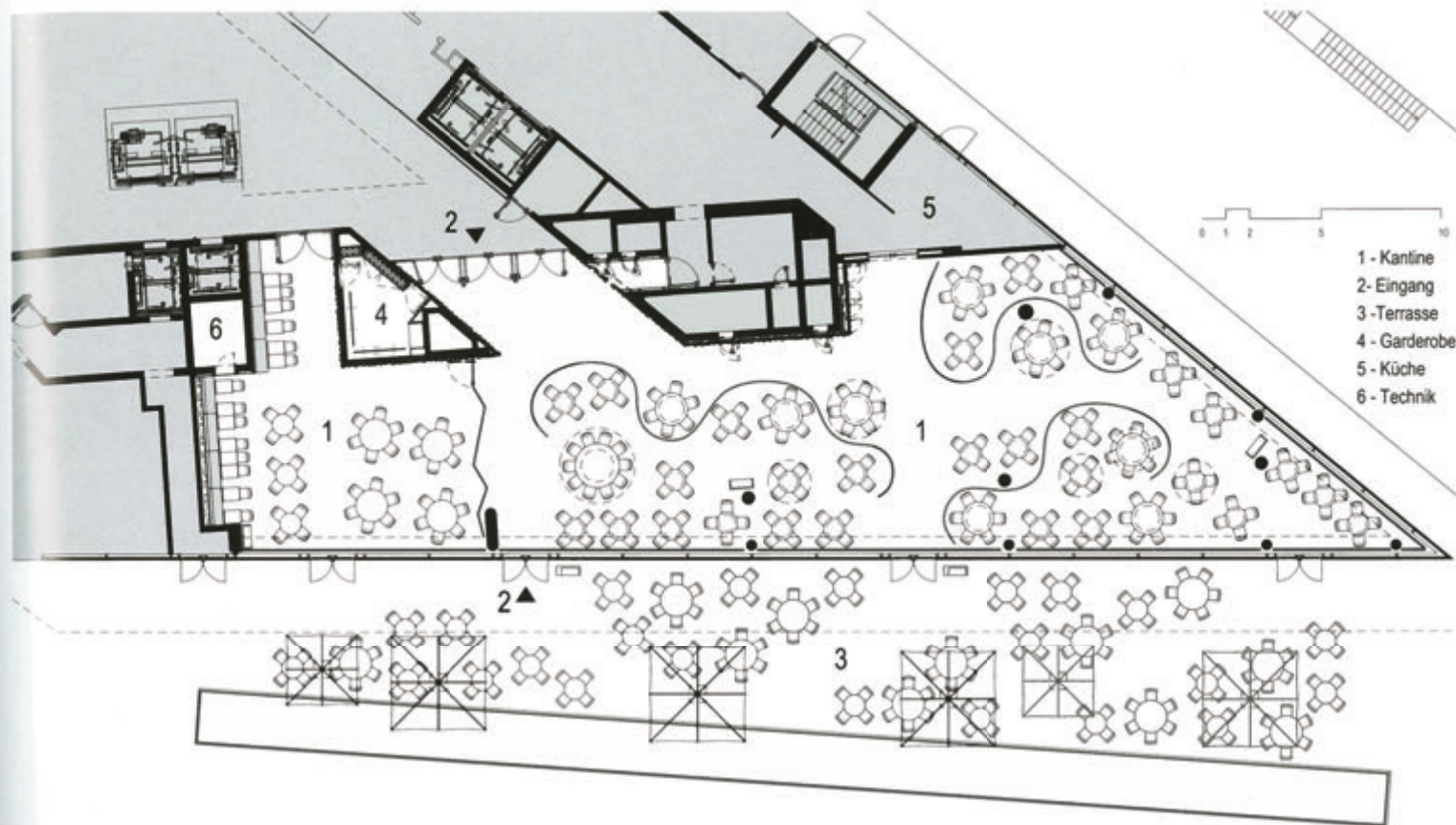

The employees' canteen was and is a calling card of the SPIEGEL Group, reflecting its journalistic philosophy as much as its culture of dialogue – not least because of its prominent position in the building and its high visibility from the exterior. Nonetheless it is a space which looks inward, only accessible to SPIEGEL employees and their guests. That means it isn't a "brand space" as such. The starting point for the designers' deliberations was the characteristics of the space and of the building. The building distinguishes itself through its exposed position on the water and its modern architecture, expressed in the vertical interior space of the 14-storey atrium. The floor plan of the canteen defines a large, polygonal space whose strong horizontal emphasis is further highlighted by the uninterrupted row of windows on two sides.



Because the space had to be flexible, it was soon clear that the ceiling design would be the distinguishing moment of the canteen. Reflecting both this fact and the harbour location, there developed a matt shimmering ceiling which reflects light in much the same manner as water. It is formed of 4,230 circles made of micro-perforated satin-polished aluminium, laminated onto noise-absorbing supporting material and set at slight angles to each other. During the day the ceiling is enlivened by water and light effects from the surrounding area. The matt shimmering "plates" absorb daylight and turn the roof into a lively, gently reflective complement to the water surface of the Ericusgraben canal. Large-scale light dishes use intense colour to divide the space into zones. This colour generates a positive atmosphere in the space, even in grey days. Dimmable lamps suspended directly above tables ensure that light levels are infinitely variable. In the evening the dishes are transformed into indirectly-lit light objects. The overall mood in the canteen is determined by the warm, white "ambient light" shed by the suspended lamps. Indirect light in selected suspended lamps discreetly illuminates the ceiling discs. Focused spotlights, hidden in the ceiling, complement the nuanced sophistication of the overall mood with light accents. Wallwashers integrated into the ceiling cast an even light on wall surfaces. They create a balance between horizontal and vertical illumination and optimise the sense of space by night, partly through reflections in glass surfaces.

The ceiling also has functional advantages: the area above the ceiling plates is painted black, along with the mandatory technical fittings, rendering them invisible. Ceiling diffusers and sprinklers effectively disappear. In addition, the upper ceiling was configured to be noise-absorbent, complementing the acoustic properties of the micro-perforated plates.

The round, communicative tables are made from black coated steel frames which seem to grow from the floor in a graceful motion. Granite plates serve as table tops, their lasered surfaces working with the ceiling lights to create glare-free, brilliant light. The tables are placed within the space in three large groups in loose arrangements and so provide an organic counterpoint to the polygonal floor plan. Movement zones are thus clearly delineated. Three lines are set into the smooth, white terrazzo floor: they ensure tables don't encroach on walkways. Along these lines four areas are arranged with removable, lightweight spatial filters composed of white, hanging rods. Large yellow light dishes support the zoning of the space just as the hanging lamps locate tables within the space. Wood panelling lends a sense of depth to structural hubs. The whitewashed, varnished surfaces appear even deeper thanks to a vertical, wavy relief which gives a textile-like effect.

Through a zigzagging glass façade a separate area can be formed at one end for discrete events or for use of the canteen late at night. A shoal of bright, hanging Plexiglas rods creates glare-free illumination and an intimate setting. The glass façade between this area and the canteen is formed of doubly reflective glass. So at times when both areas are in use, the separation is almost immaterial. However when the canteen is closed and thus darker, the façade appears half-mirrored, half-transparent.

The employees' canteen in the SPIEGEL Group's new headquarters is a space that meets all functional demands while creating a strong visual impact to form a truly distinguishing space. In so doing it supports the mature culture of communication within the company and in a grand gesture transmits these values to the outside world.